

# PERNI A SALDARE

---



Perni a saldare

## Perni a saldare

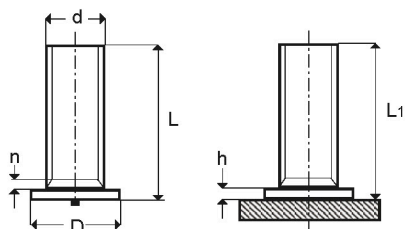

## Perni filettati



### Materiale

Acciaio St 36-2 ramato	Inox Aisi 304	Alluminio ALMg3
---------------------------	------------------	--------------------

Dimensioni in mm

Tipo	Codice acciaio	Codice Inox	Codice Alluminio	d	L +0,6	D +0,3 -0,3	h	n max	L1
M 3 x 6	434 303	434 503	434 403	M 3	6,0	4,5	0,7-1,4	1,0	L +/- 0,3
M 3 x 8	434 304	434 504	434 404		8,0				
M 3 x 10	434 305	434 505	434 405		10,0				
M 3 x 12	434 306	434 506	434 406		12,0				
M 3 x 15	434 314	-	434 407		15,0				
M 3 x 16	434 315	434 515	434 415		16,0				
M 3 x 20	434 316	434 516	434 416		20,0				
M 3 x 25	434 317	434 517	434 417		25,0				
M 4 x 6	434 323	434 523	434 423		M 4				
M 4 x 8	434 324	434 524	434 424	8,0					
M 4 x 10	434 325	434 525	434 425	10,0					
M 4 x 12	434 326	434 526	434 426	12,0					
M 4 x 15	434 327	434 527	434 427	15,0					
M 4 x 16	434 328	434 528	434 428	16,0					
M 4 x 20	434 330	434 530	434 430	20,0					
M 4 x 25	434 332	434 532	434 432	25,0					
M 4 x 30	434 334	434 534	434 434	30,0					
M 4 x 35	434 336	434536	434 436	35,0					

Tipo	Codice acciaio	Codice Inox	Codice Alluminio	d	L +0,6	D +0,3 -0,3	h	n max	L1				
M 5 x 6	434 343	-	-	M 5	6,0	6,5	0,8-1,4	2,0	L +/- 0,3				
M 5 x 8	434 344	434 544	434 444		8,0	7,0							
M 5 x 10	434 345	434 545	434 445		10,0	6,5							
M 5 x 12	434 346	434 546	434 446		12,0	7,0							
M 5 x 15	434 347	434 547	434 447		15,0								
M 5 x 16	434 348	434 548	434 448		16,0								
M 5 x 20	434 350	434 550	434 450		20,0								
M 5 x 20	434 360	-	-		20,0	6,5							
M 5 x 25	434 352	434 552	434 452		25,0	7,0							
M 5 x 25	434 361	-	-		25,0	6,5							
M 5 x 30	434 353	434 553	434 453		30,0								
M 5 x 35	434 354	434 554	434 454		35,0								
M 5 x 40	434 355	434 555	434 455		40,0								
M 6 x 8	434 364	434 564	434 464		M 6	8,0				7,5	0,8-1,4	2,0	L +/- 0,3
M 6 x 10	434 365	434 565	434 465	10,0									
M 6 x 12	434 366	434 566	434 466	12,0									
M 6 x 15	434 367	434 567	434 467	15,0									
M 6 x 16	434 368	434 568	434 468	16,0									
M 6 x 20	434 370	434 570	434 470	20,0									
M 6 x 25	434 372	434 572	434 471	25,0									
M 6 x 30	434 373	434 573	434 472	30,0									
M 6 x 35	434 374	434 574	434 473	35,0									
M 6 x 40	434 375	434 575	434 474	40,0									
M 6 x 45	434 376	434 576	434 475	45,0									
M 6 x 50	434 377	434 577	434 476	50,0									
M 8 x 10	434 382	434 584	434 482	M 8		10,0	9,0	0,8-1,4	2,0	L +/- 0,3			
M 8 x 15	434 384	434 586	434 484			15,0							
M 8 x 20	434 386	434 587	434 486		20,0								
M 8 x 25	434 388	434 588	434 488		25,0								
M 8 x 30	434 389	434 589	434 489		30,0								
M 8 x 35	434 390	434 590	434 490		35,0								
M 8 x 40	434 391	434 591	434 491		40,0								
M 8 x 40	434 399	-	-		40,0								
M 8 x 45	434 392	-	434 492		45,0								
M 8 x 50	434 393	-	434 493		50,0								

## Perni a saldare

### Perni

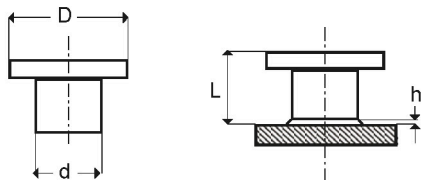

#### Materiale

Acciaio St. 36-2 ramato	Inox Aisi 304
----------------------------	------------------

Tipo	Codice acciaio	Codice Inox	d	L +0,1 -0,1	D +0,15 -0,05	h
3 x 3,9	<b>434 101</b>	<b>434 100</b>	<b>3,0</b>	3,9	5,0	-
5 x 10	<b>434 111</b>	<b>434 110</b>	<b>5,0</b>	10,0	9,0	-

## Perni a saldare

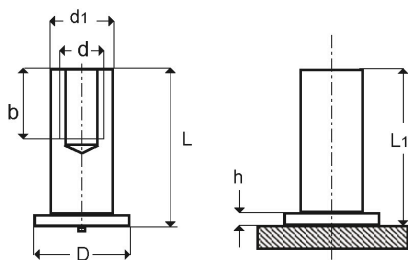

### Distanziali filettati



#### Materiale

Acciaio St 36-2 ramato	Inox Aisi 304	Alluminio ALMg3
------------------------	---------------	-----------------

Dimensioni in mm

Tipo	Codice acciaio	Codice Inox	Codice Alluminio	d	L +0,6	D +0,3	h +0,2 -0,2	d1 -0,05	b +0,5	L1	
M 3 x 8	434 810	-	434 844	M 3	8,0	7,0	0,5	5,0	5,0	L +/- 0,3	
M 3 x 10	434 811	-	-		10,0						
M 3 x 12	434 812	-	434 843		12,0						
M 3 x 15	434 813	-	-		15,0						
M 3 x 20	434 814	-	-		20,0						
M 3 x 25	434 815	-	-		25,0						
M 3 x 30	434 816	-	-		30,0						
-	-	-	-	M 4	10,0	7,5	0,6	6,0	6,0	L +/- 0,3	
M 4 x 12	434 821	-	-		12,0						
M 4 x 15	434 822	-	-		15,0						
M 4 x 20	434 826	-	-		20,0						
M 4 x 25	434 824	-	-		25,0						
M 4 x 30	434 825	-	-		30,0						
M 5 x 12	434 831	-	-		M 5						12,0
M 5 x 15	434 832	-	-	15,0							
M 5 x 20	434 864	-	-	20,0							

